

PB-52 & PB-52 TC

RECESSED CONTACTS

.75"(19mm) Reed Push-Button Jamb-Switch



Contact Size:

PB-52: .75"×1.7"(19mm×43.3mm)

PB-52 TC: .75"×1.73"(19mm×44mm)

Standard Magnet Size: NA

Standard Gap: NA

Colors: White, Brown

12"(305mm) 22 AWG Leads Standard PB-52

Longer leads available.

PB-52 TC: Terminal Connect, No Leads.

Specifications

Part Number	Gap Inch(mm)	Loop Open/Closed	Reed Form	Max. Contact Rating (W)	Max. Initial Contact Resistance (mΩ)	Max. Switching Voltage (V)	Max. Switching Current (A)
PB-52	NA	CLOSED	Normally Open	10	100	AC110/DC100	0.5
PB-52 TC	NA	CLOSED	Normally Open	10	100	AC110/DC100	0.5

OPERATING TEMPERATURE:-40°C to +60°C

Outline Dimensions

Unit: inch(mm)

PB-52

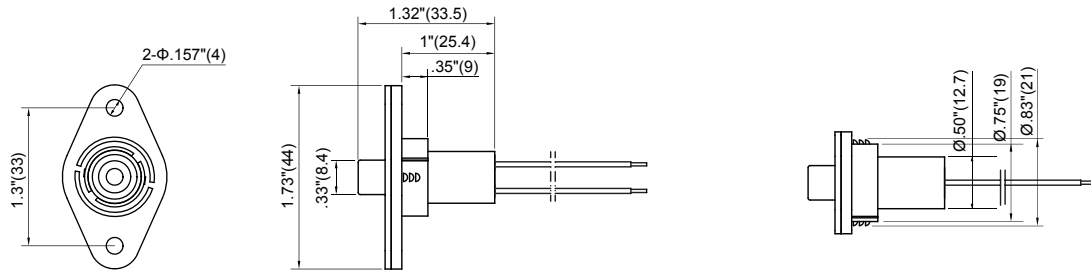

PB-52 TC

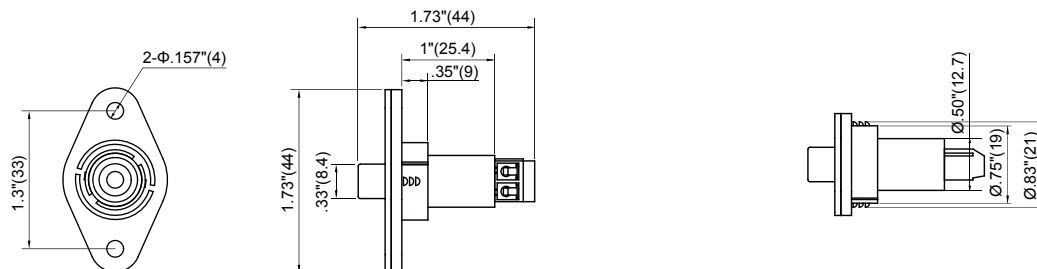

The Best Guarantee Since 1984 : \$50-1

TANE ALARM PRODUCTS

906 JERICHO TURNPIKE, NEW HYDE PARK, NY 11040

Tel: 800-852-5050 • 516-328-3351 • Fax: 516-326-9125

www.tanealarm.com • E-MAIL: info@tanealarm.com